

Audi Q7

Current Flow Diagram

No. 33 / 1

Edition 04.2007

Heated front and rear seats

from model year 2007

Notes:

For information concerning

- ◆ Position of relays and fuses
- ◆ Multi-pin connections
- ◆ Control units and relays
- ◆ Earth connections

→ List of Fitting Locations!

For information concerning

- ◆ Fault Finding Programs

→ guided fault finding

Audi Q7

Current Flow Diagram

No. 33 / 2

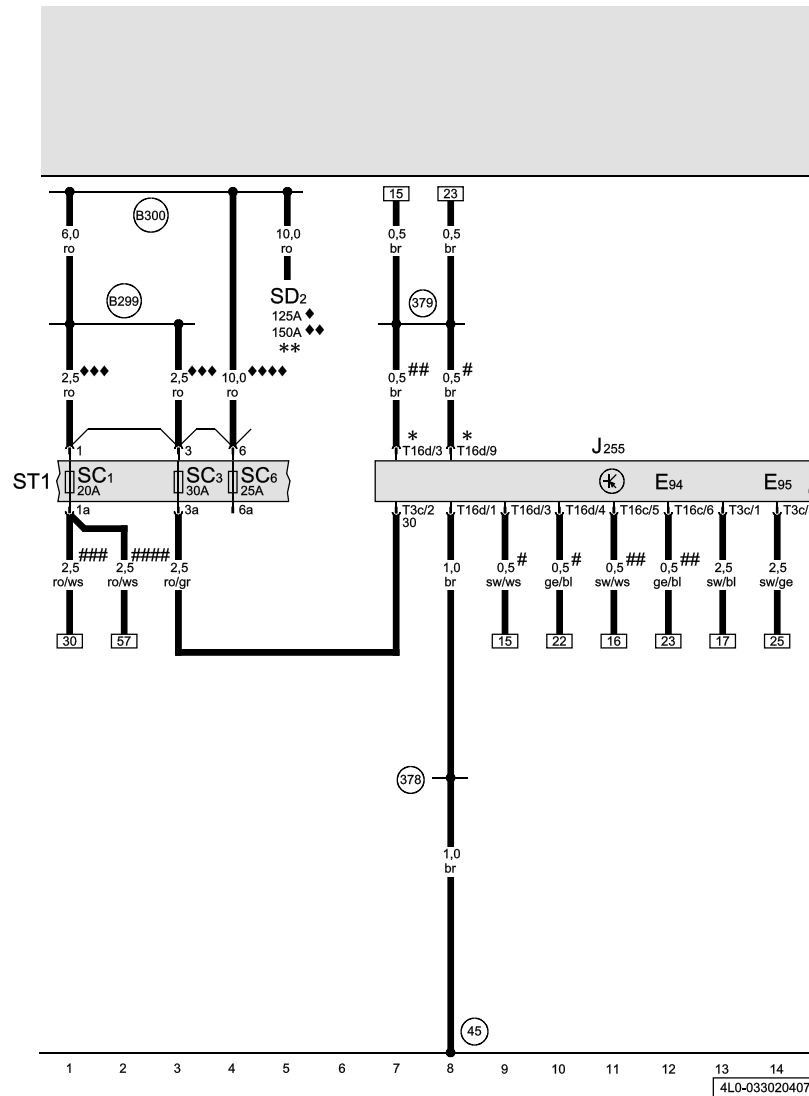

ws = white
 sw = black
 ro = red
 rt = red
 br = brown
 gn = green
 bl = blue
 gr = grey
 li = purple
 vi = purple
 ge = yellow
 or = orange
 rs = pink

Climatronic control unit, heated driver seat regulator, heated front passenger seat regulator, fuses

- E94 - Heated driver seat regulator
- E95 - Heated front passenger seat regulator
- J255 - Climatronic control unit
- SC1 - Fuse 1 on fuse holder C
- SC3 - Fuse 3 on fuse holder C
- SC6 - Fuse 6 on fuse holder C
- SD2 - Fuse 2 on fuse holder D
- T3c - 3-pin connector, black, connector E, on Climatronic control unit
- T16c - 16-pin connector, brown, connector C, on Climatronic control unit
- T16d - 16-pin connector, black, connector D, on Climatronic control unit
- 45 - Earth point, centre behind dash panel
- 378 - Earth connection 13, in main wiring harness
- 379 - Earth connection 14, in main wiring harness
- B299 - Positive connection 3 (30), in main wiring harness
- B300 - Positive connection 4 (30), in main wiring harness
- * - output sender earth
- ** - Relay and fuse carrier under driver seat
- # - Air conditioning system basis
- ## - Convenience air conditioning system
- ### - models without operating and display unit for rear Climatronic
- #### - models with operating and display unit for rear Climatronic
- ◆ - up to May 2006
- ◆◆ - from June 2006
- ◆◆◆ - up to May 2007
- ◆◆◆◆ - from June 2007

4L0-033020407

Audi Q7

Current Flow Diagram

No. 33 / 3

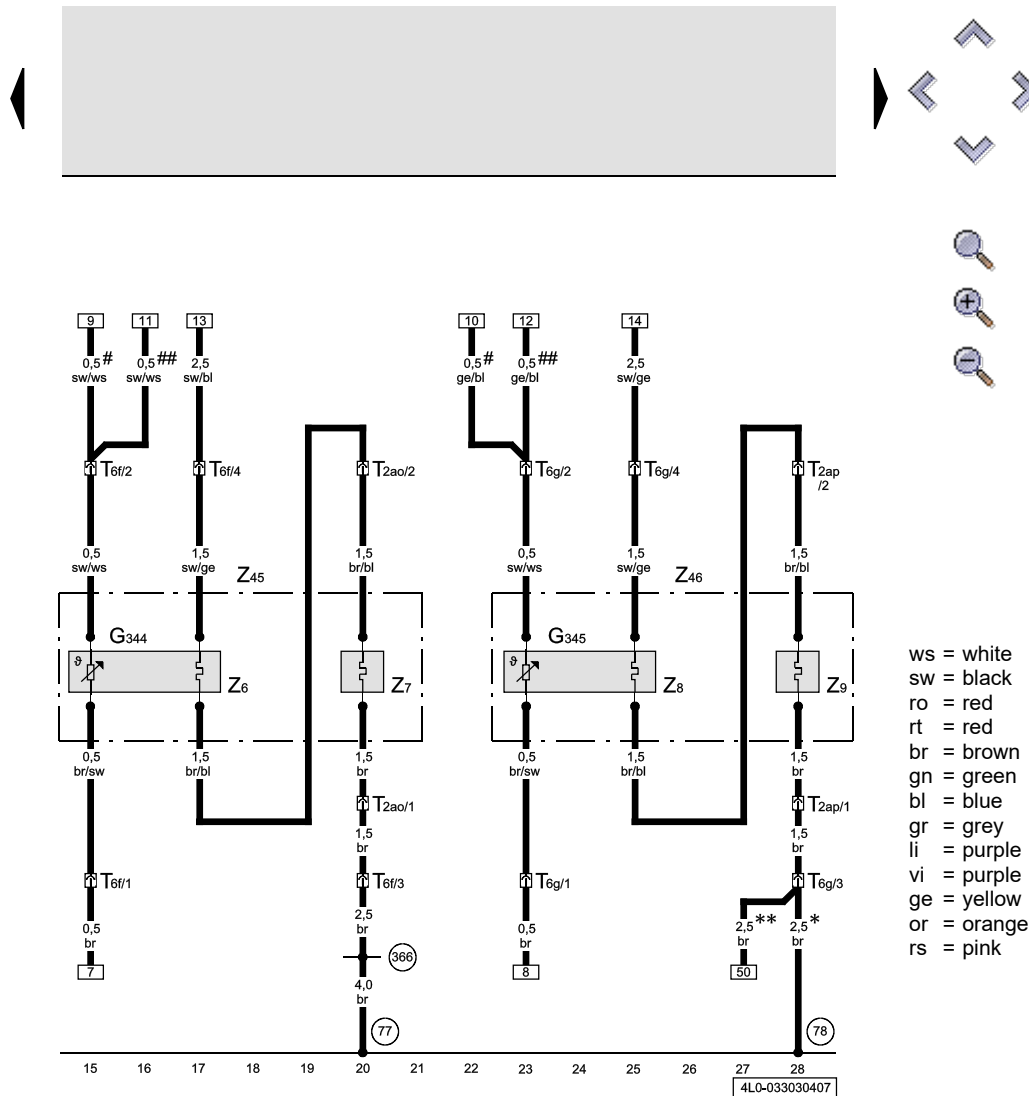

Front left seat temperature sender, front right seat temperature sender, heated driver seat cushion, heated driver seat backrest, heated front passenger seat cushion, heated front passenger seat backrest

G344 - Front left seat temperature sender

G345 - Front right seat temperature sender

T2ao - 2-pin connector, black, under the seat on front left

T2ap - 2-pin connector, black, under the seat on front right

T6f - 6-pin connector, green, under driver seat

T6g - 6-pin connector, green, under front passenger seat

Z6 - Heated driver seat cushion

Z7 - Heated driver seat backrest

Z8 - Heated front passenger seat cushion

Z9 - Heated front passenger seat backrest

Z45 - Front left seat heating

Z46 - Front right seat heating

77 - Earth point, lower part of left B-pillar

78 - Earth point, lower part of right B-pillar

366 - Earth connection 1, in main wiring harness

- Air conditioning system basis

- Convenience air conditioning system

* - up to May 2007

** - from June 2007

Audi Q7

Current Flow Diagram

No. 33 / 4

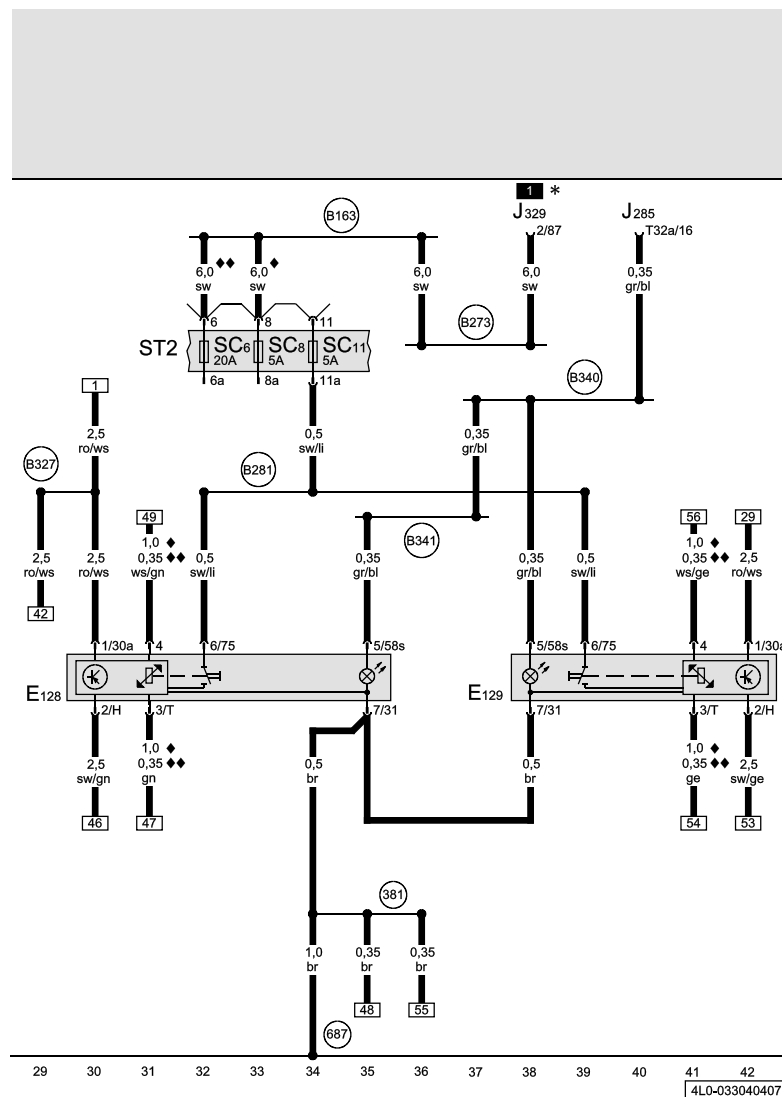

ws = white
 sw = black
 ro = red
 rt = red
 br = brown
 gn = green
 bl = blue
 gr = grey
 li = purple
 vi = purple
 ge = yellow
 or = orange
 rs = pink

Heated rear left seat switch with regulator, heated rear right seat switch with regulator, fuses

- E128 - Heated rear left seat switch with regulator
- E129 - Heated rear right seat switch with regulator
- J285 - Control unit in dash panel insert
- J329 - Terminal 15 voltage supply relay
- SC6 - Fuse 6 on fuse holder C
- SC8 - Fuse 8 on fuse holder C
- SC11 - Fuse 11 on fuse holder C
- T32a - 32-pin connector, grey, on control unit in dash panel insert
- 381 - Earth connection 16, in main wiring harness
- 687 - Earth point 1, on centre tunnel
- B163 - Positive connection 1 (15), in interior wiring harness
- B273 - Positive connection (15), in main wiring harness
- B281 - Positive connection 5 (15a), in main wiring harness
- B327 - Positive connection 13 (30a), in main wiring harness
- B340 - Connection 1 (58s), in main wiring harness
- B341 - Connection 2 (58s), in main wiring harness
- * - Relay and fuse carrier under driver seat
- ♦ - up to May 2007
- ♦♦ - from June 2007

4L0-033040407

Audi Q7

Current Flow Diagram

No. 33 / 5

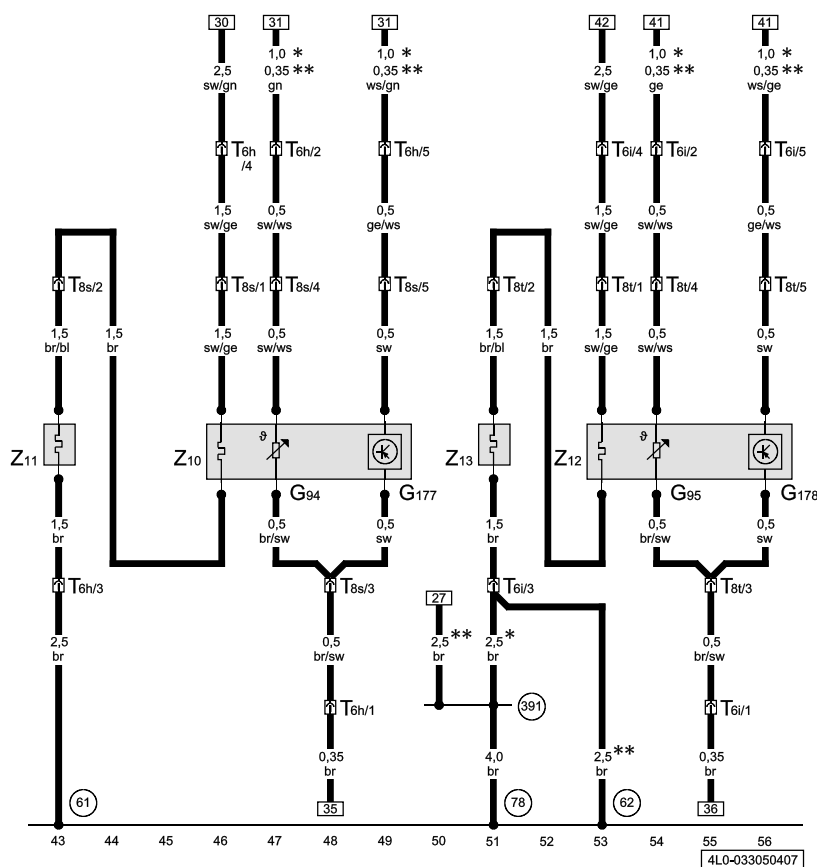
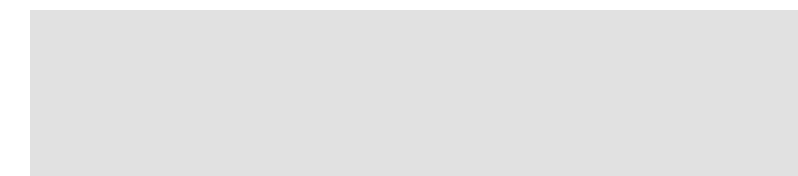

ws = white
 sw = black
 ro = red
 rt = red
 br = brown
 gn = green
 bl = blue
 gr = grey
 li = purple
 vi = purple
 ge = yellow
 or = orange
 rs = pink

Heated rear seat, without rear Climatronic operating and display unit, rear left and right seat temperature sensor, rear seat occupied sensor on driver and front passenger side

- G94 - Rear left seat temperature sensor
- G95 - Rear right seat temperature sensor
- G177 - Rear seat occupied sensor on driver side
- G178 - Rear seat occupied sensor on front passenger side

- T6h - 6-pin connector, green, under rear seat, left
- T6i - 6-pin connector, green, under rear seat, right

- T8s - 8-connector, black, in rear seat, left
- T8t - 8-connector, black, in rear seat, right
- Z10 - Heated rear left seat
- Z11 - Heated rear left seat backrest
- Z12 - Heated rear right seat
- Z13 - Heated rear right seat backrest

- 61 - Earth point, left C-pillar
- 62 - Earth point, right C-pillar
- 78 - Earth point, lower part of right B-pillar
- 391 - Earth connection 26, in main wiring harness
- * - up to May 2007
- ** - from June 2007

4L0-033050407

Audi Q7

Current Flow Diagram

No. 33 / 6

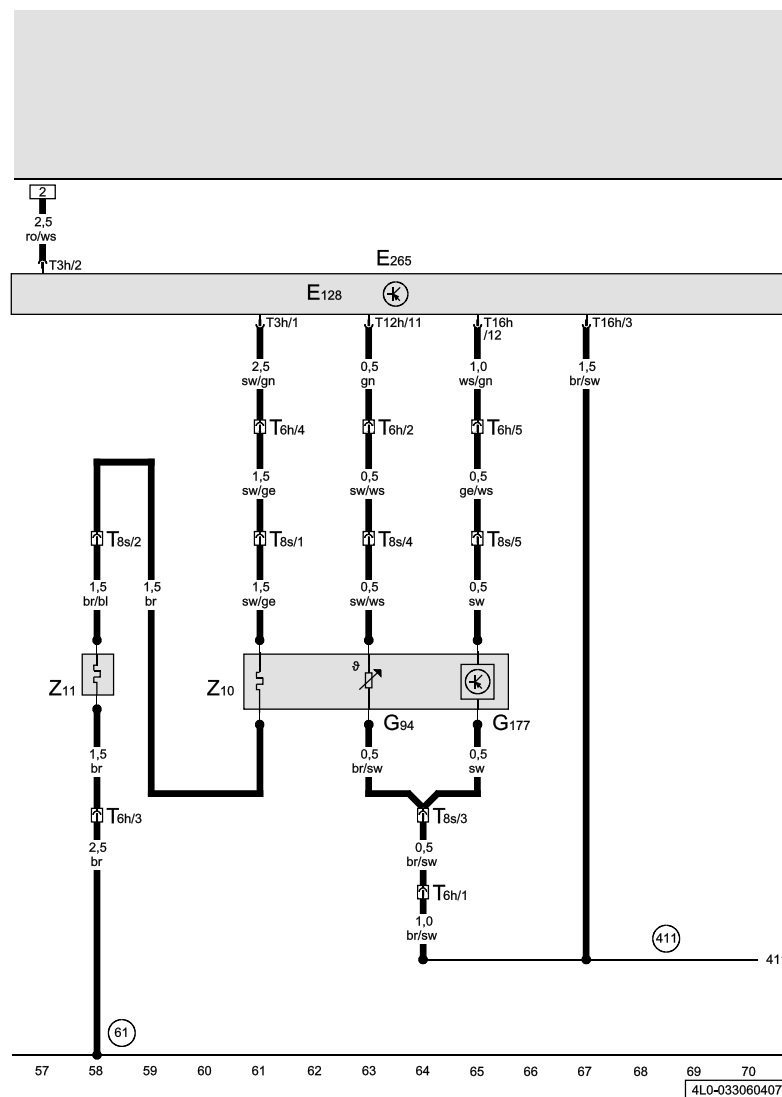

Heated rear seat with rear Climatronic operating and display unit, rear left seat temperature sensor, rear seat occupied sensor on driver side

- E128 - Heated rear left seat switch with regulator
- E265 - Operating and display unit for rear Climatronic
- G94 - Rear left seat temperature sensor
- G177 - Rear seat occupied sensor on driver side
- T3h - 3-pin connector, black, connector E, on rear Climatronic operating and display unit
- T6h - 6-pin connector, green, under rear seat, left
- T8s - 8-pin connector, black, in rear seat, left
- T12h - 12-pin connector, connector A, on rear Climatronic operating and display unit
- T16h - 16-pin connector, connector D, on rear Climatronic operating and display unit
- Z10 - Heated rear left seat
- Z11 - Heated rear left seat backrest
- 61 - Earth point, left C-pillar
- 411 - Earth connection 2 (sender earth), in main wiring harness

ws = white
sw = black
ro = red
rt = red
br = brown
gn = green
bl = blue
gr = grey
li = purple
vi = purple
ge = yellow
or = orange
rs = pink

Audi Q7

Current Flow Diagram

No. 33 / 7

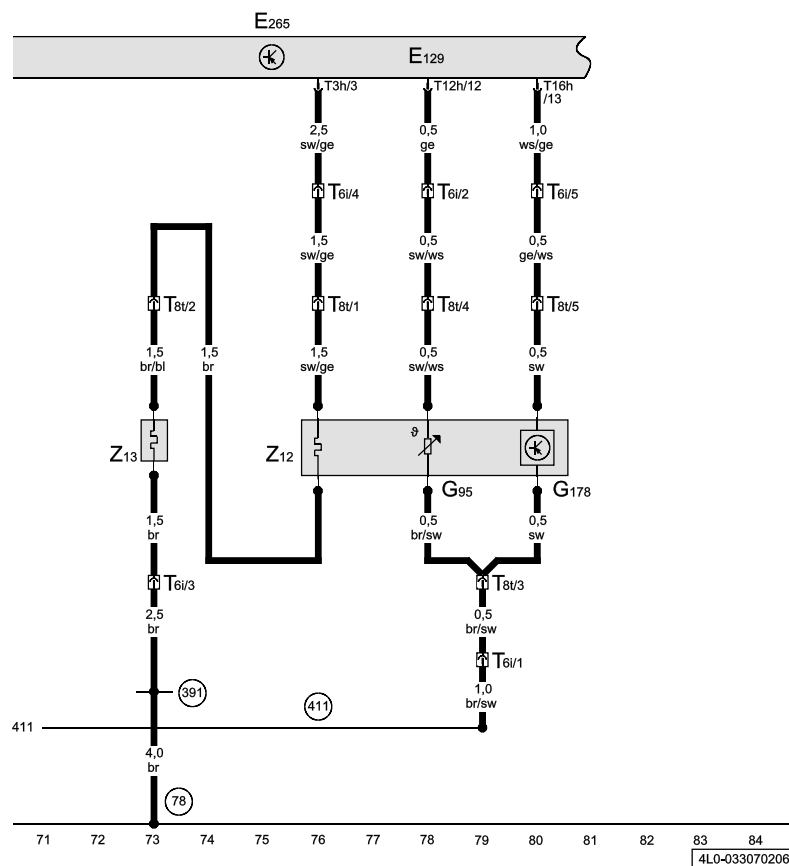
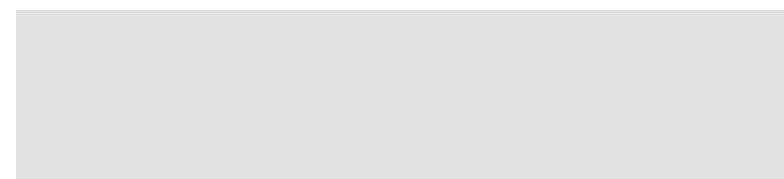

Heated rear seat with rear Climatronic operating and display unit, rear right seat temperature sensor, rear seat occupied sensor on front passenger side

E129 - Heated rear right seat switch with regulator

E265 - Operating and display unit for rear Climatronic

G95 - Rear right seat temperature sensor

G178 - Rear seat occupied sensor on front passenger side

T3h - 3-pin connector, black, connector E, on rear Climatronic operating and display unit

T6i - 6-pin connector, green, under rear seat, right

T8t - 8-connector, black, in rear seat, right

T12h - 12-pin connector, connector A, on rear Climatronic operating and display unit

T16h - 16-pin connector, connector D, on rear Climatronic operating and display unit

Z12 - Heated rear right seat

Z13 - Heated rear right seat backrest

78 - Earth point, lower part of right B-pillar

391 - Earth connection 26, in main wiring harness

411 - Earth connection 2 (sender earth), in main wiring harness