

Removing and installing bonnet release cable

1 - Bonnet release cable

- ❑ Removing:
- ❑ Removing storage compartment (driver's side) → Rep. gr.68
- ❑ Unclip cable from bonnet lock (bottom section) and disengage eyelet.
- ❑ Installing:
- ❑ Install in reverse order.
- ❑ Move ball on Bowden cable at bonnet lock (bottom section) into installation position.

2 - Operating lever

3 - Grommet

- ❑ When installing, ensure correct seating of grommet.

4 - Seal

- ❑ Pressed into hole in wing mounting flange

5 - Wing

6 - Bonnet lock (bottom section)

- ❑ Removing and installing → Fig.
- ❑ Can be adjusted to set height of bonnet

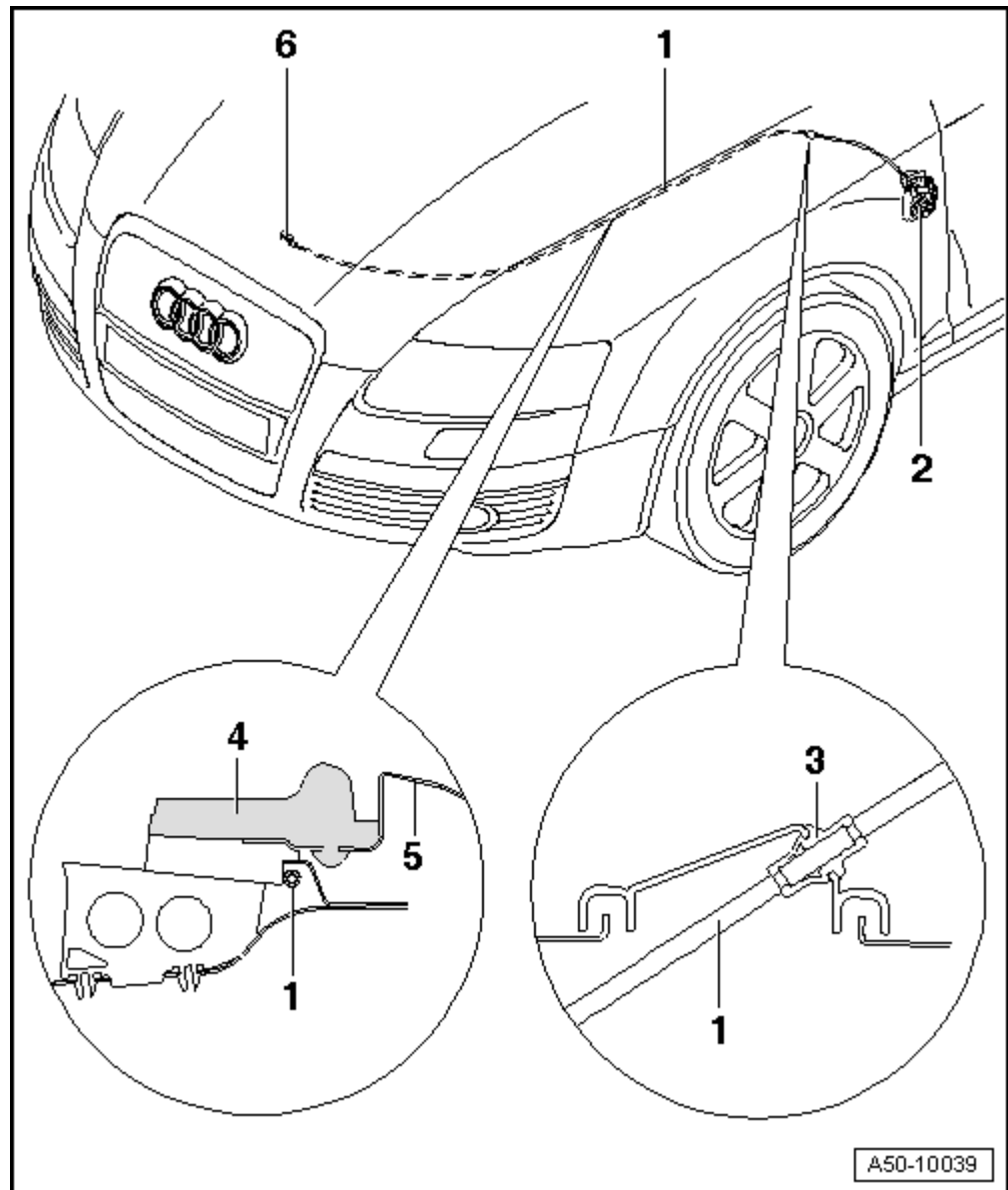

A50-10039