

Removing and installing coolant pump and compact bracket

1 - Viscous fan coupling

- Removing and installing → Chapter.

2 - Pulley

- For viscous fan coupling

3 - 30 Nm

4 - O-ring

- Renew.

5 - 25 Nm

- Only tighten if injection pump is bolted securely to bracket
- Observe tightening sequence → Fig..

6 - Threaded bush

- Drive in before installing compact bracket

7 - Dowel sleeve

- Renew if damaged.

8 - Compact bracket

- For coolant pump, thermostat, poly V-belt tensioning roller, alternator and power steering vane pump

9 - Bracket

10 - 45 Nm

11 - 25 Nm

- Observe tightening sequence → Fig..

12 - Thermostat

- Checking: Heat up thermostat in water.

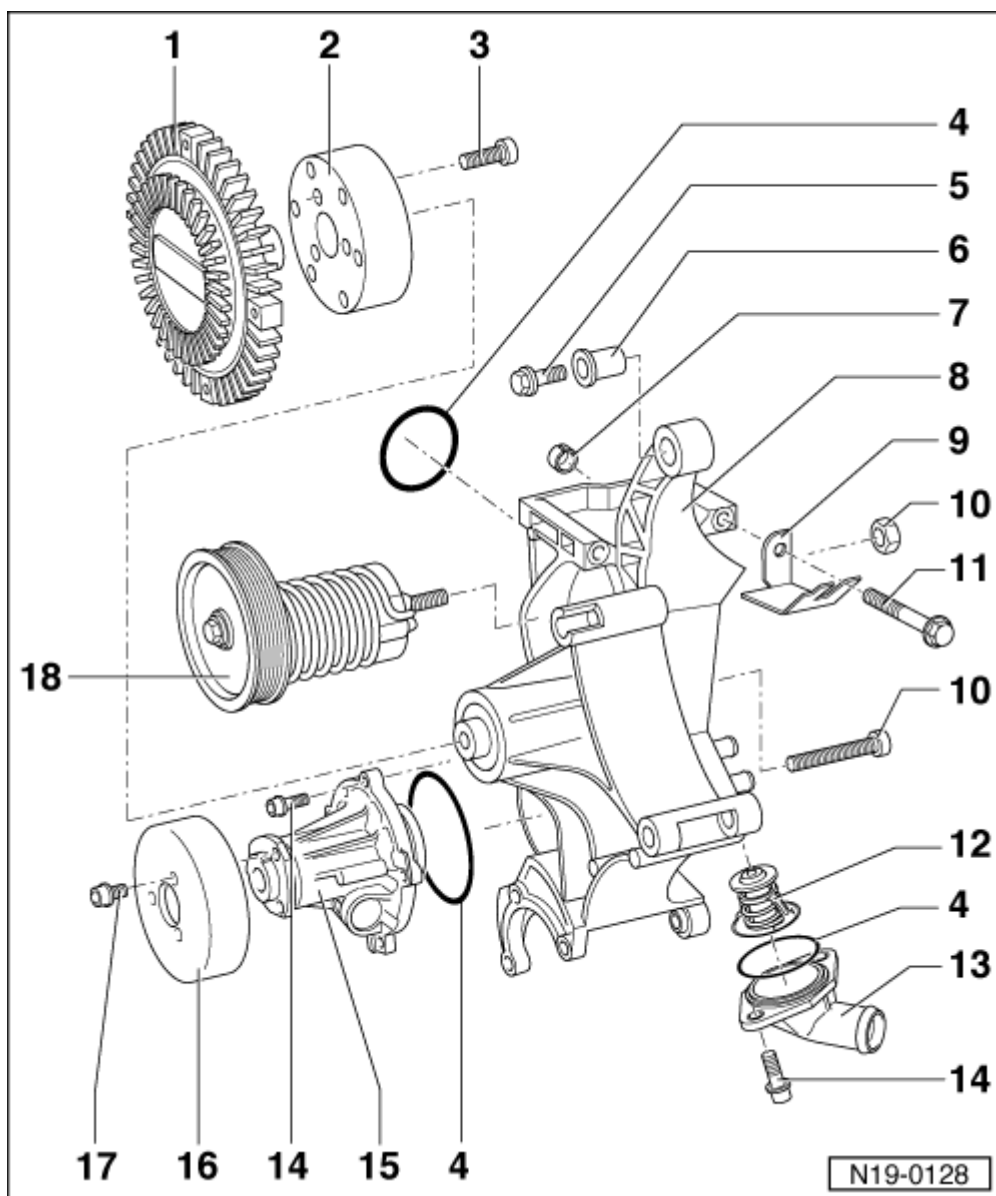

- ❑ Opening begins at approx. 85 °C.
- ❑ Ends at approx. 105 °C
- ❑ Opening lift min. 7 mm.

13 - Connection

14 - 10 Nm

15 - Coolant pump

- ❑ Check for ease of movement.

16 - Pulley

- ❑ For coolant pump.

17 - 25 Nm

18 - Tensioning element

- ❑ For poly V-belt
- ❑ Remove viscous fan coupling before removing → [Chapter](#)

Tightening sequence, compact bracket to cylinder block

- Place compact bracket on cylinder block (observe dowel sleeve between compact bracket and cylinder block).
- Tighten compact bracket as shown in following tightening sequence:
 - 1 - Tighten bolt -A- to 25 Nm
 - 2 - Tighten bolt -B- to 25 Nm
 - 3 - Tighten bolt -C- to 25 Nm
 - 4 - Tighten bolt -D- to 25 Nm
 - 5 - Tighten bolt -E- to 25 Nm (injection pump must be bolted securely to bracket)
 - 6 - Tighten bolt -F- to 10 Nm

